

2J6510M

433 MHz ISM Magnetic Mount

Key Features

- 433 MHz ISM**
- 433-435 MHz
- Magnetic Mount
- Ground Plane Dependent
- Customizable Cable and Connector
- Dimensions \varnothing 135.5 x 30 mm
- Certificates: IK09, IP67, IP69K



1. Antenna and electrical specifications

Parameters	433 MHz ISM Antenna
Standards	ISM, LoRa
Band (MHz)	433 MHz
Frequency (MHz)	433-435
Return Loss (dB)	~-27.5
VSWR	~1.1:1
Efficiency (%)	~58.1
Peak Gain (dBi)	~2.9
Average Gain (dB)	~-2.3
Impedance (Ohm)	50
Polarisation	Linear
Radiation Pattern	Omni-Directional
Max. Input Power (W)	50
Connector Type	SMA-Male Standard (Other Connectors Available)
Cable Length	300 cm Standard (Any Cable Length Available)
Cable Type	RG58 Standard (Other Cables Available)

Antenna Measurement Conditions:

Mounted on 60 x 60 cm Metal Plate

200cm of RG58 Cable

Measured in Certified CTIA 3D Anechoic Chamber

2. Mechanical and environmental specifications

Specifications	2J6510M
Mounting Type	Magnetic Mount
Dimensions (mm)	Ø 135.5 x 30
Radome	ABS
Radome color	Black
Antenna Base	Zamak
Gasket	TPE
Operating Temperature (C)	-40 to +85
Storage Temperature (C)	-40 to +85
Substance Compliance	RoHS
Certificates	IK09, IP67, IP69K

3. Antenna parameters

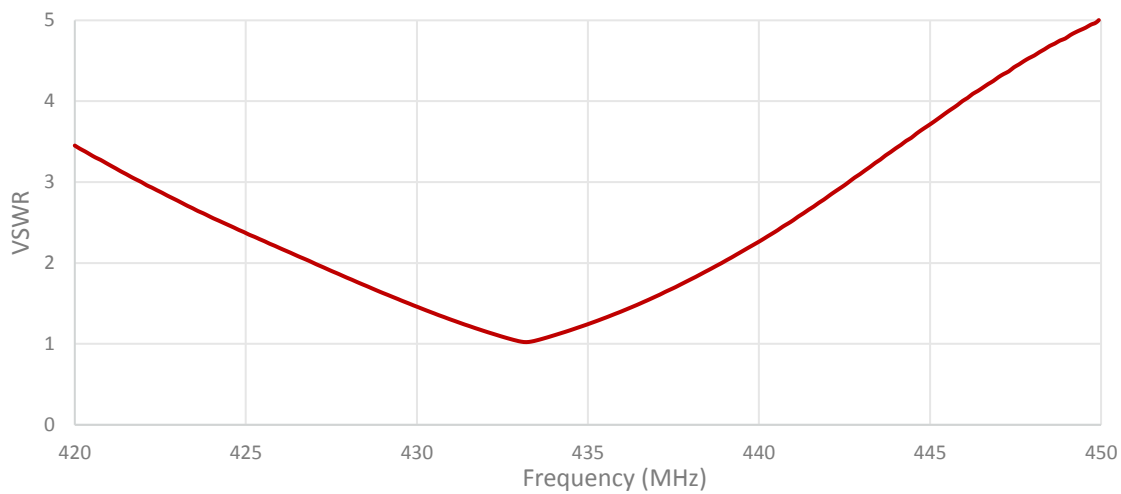
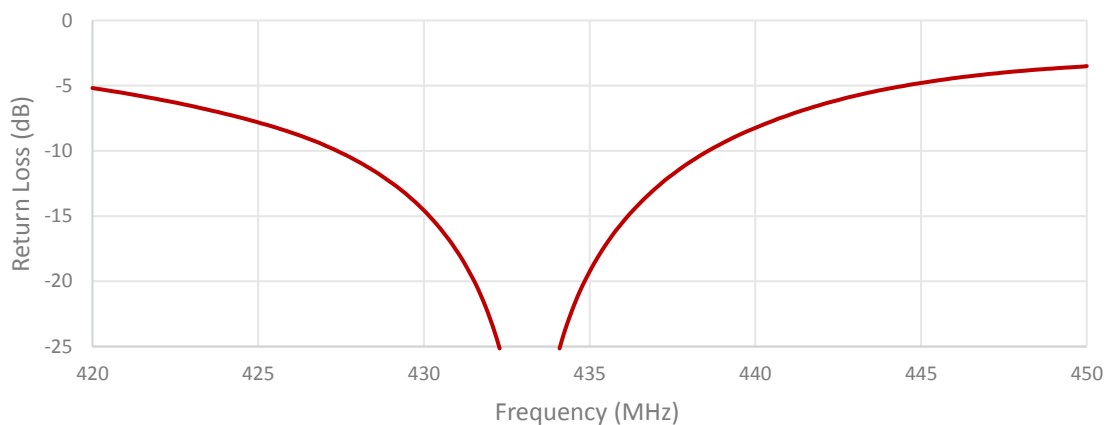

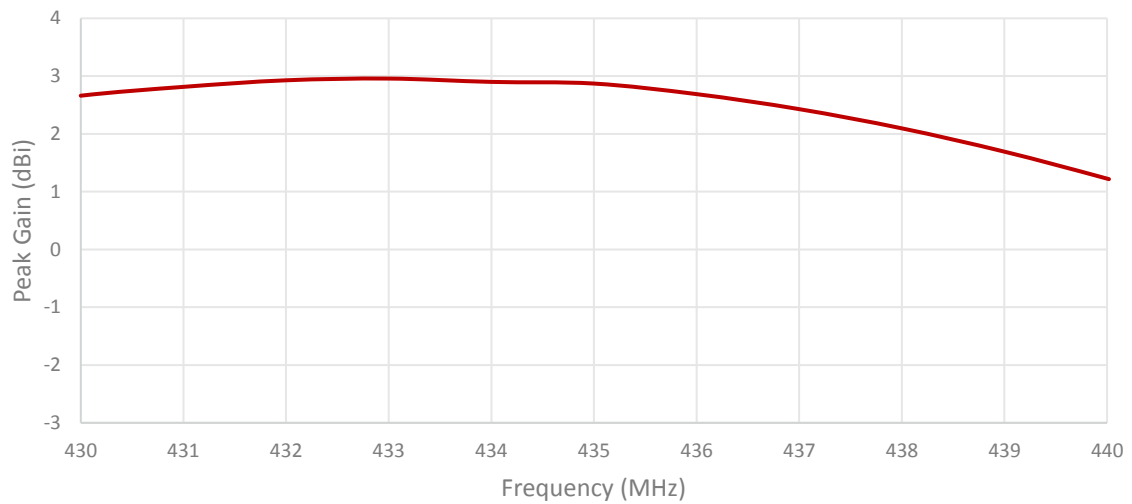
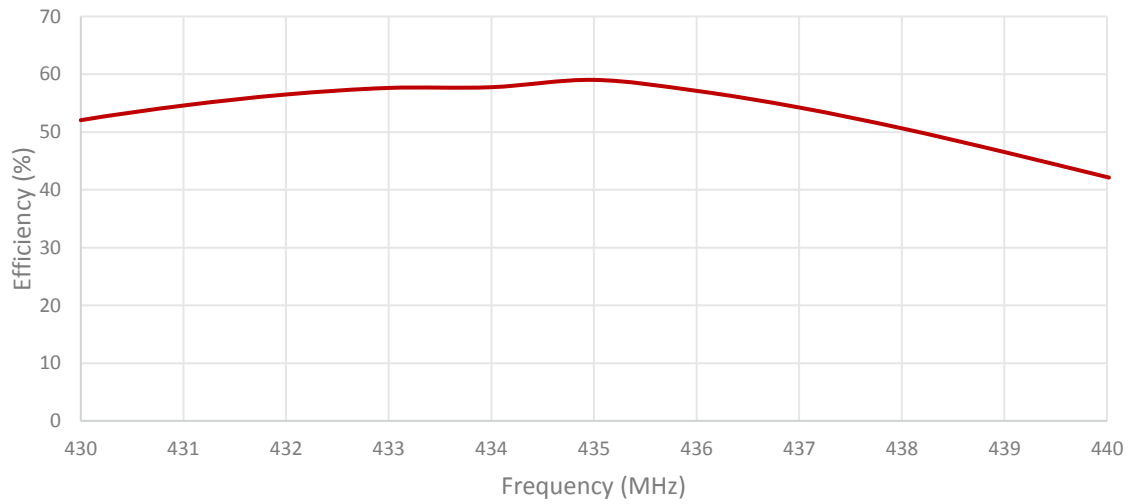

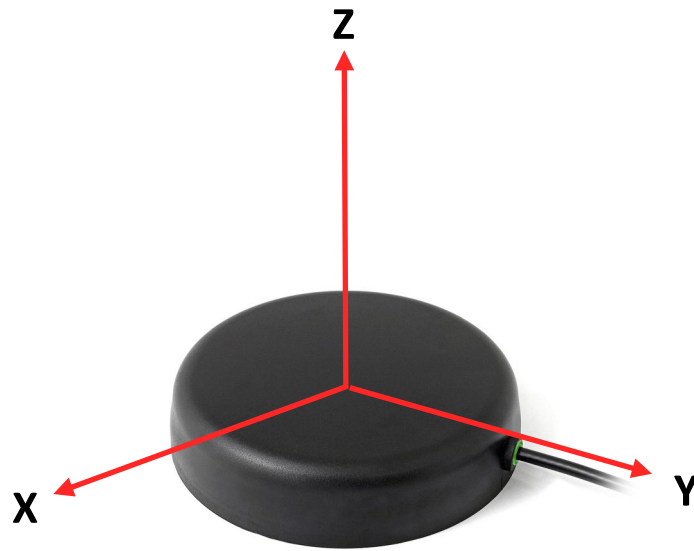
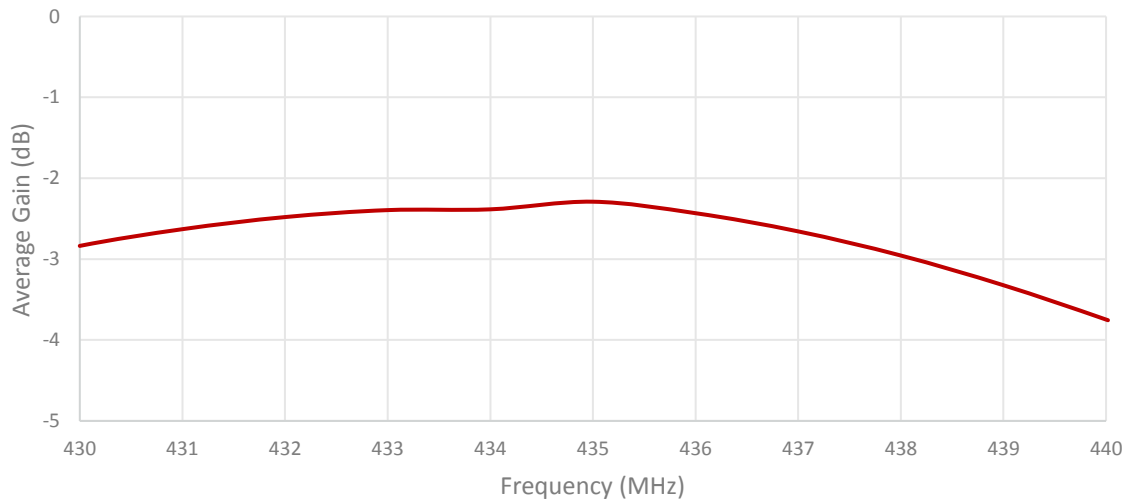

Radiation pattern reference

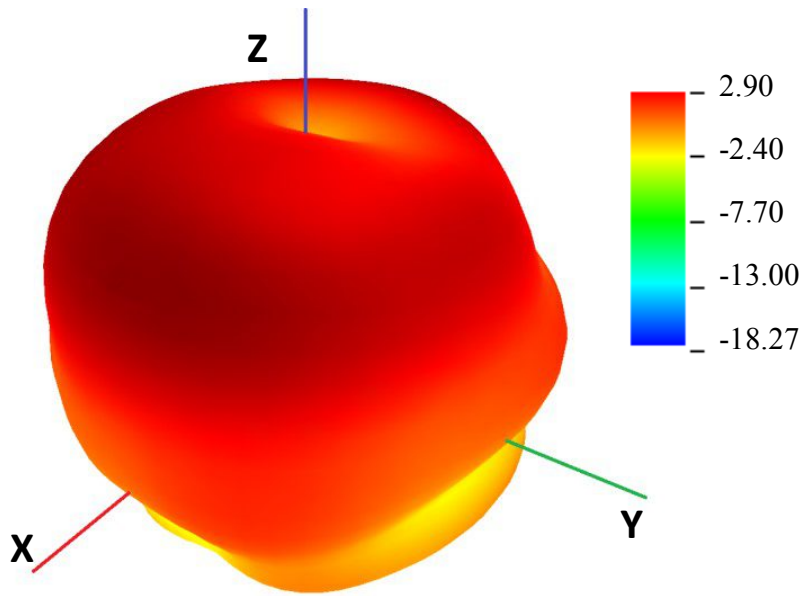

433 MHz Radiation pattern

4. Antenna drawings

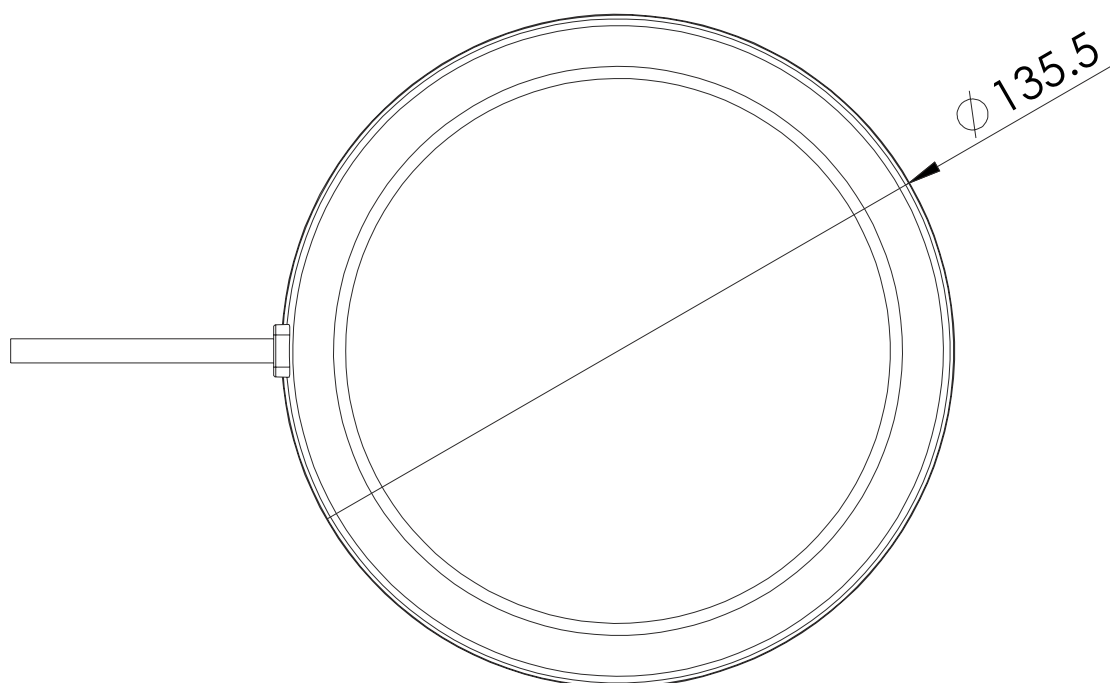
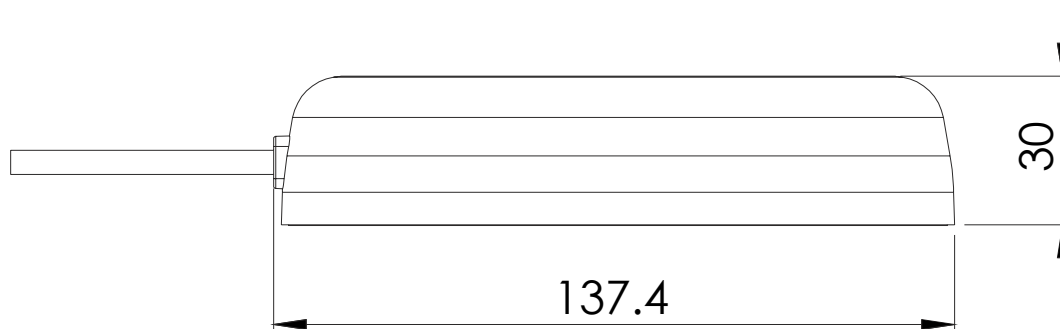

5. Antenna Images

